

SHEET NO 2
PLAN NO 1807

FOR THE IMPROVEMENT OF
MUSCUIPABE DRIVE
BETWEEN

HIGHLAND AVENUE AND MARSHALL BOULEVARD

CITY OF SAN BERNARDINO
CALIFORNIA

NOVEMBER 1948

R. D. FORSYTHE
ACTING CITY ENGINEER

PLAN ADOPTED February 21, 1949

FIELD RECORD

*As Constructed
By R.D.F.
at 13-1050
Shane*

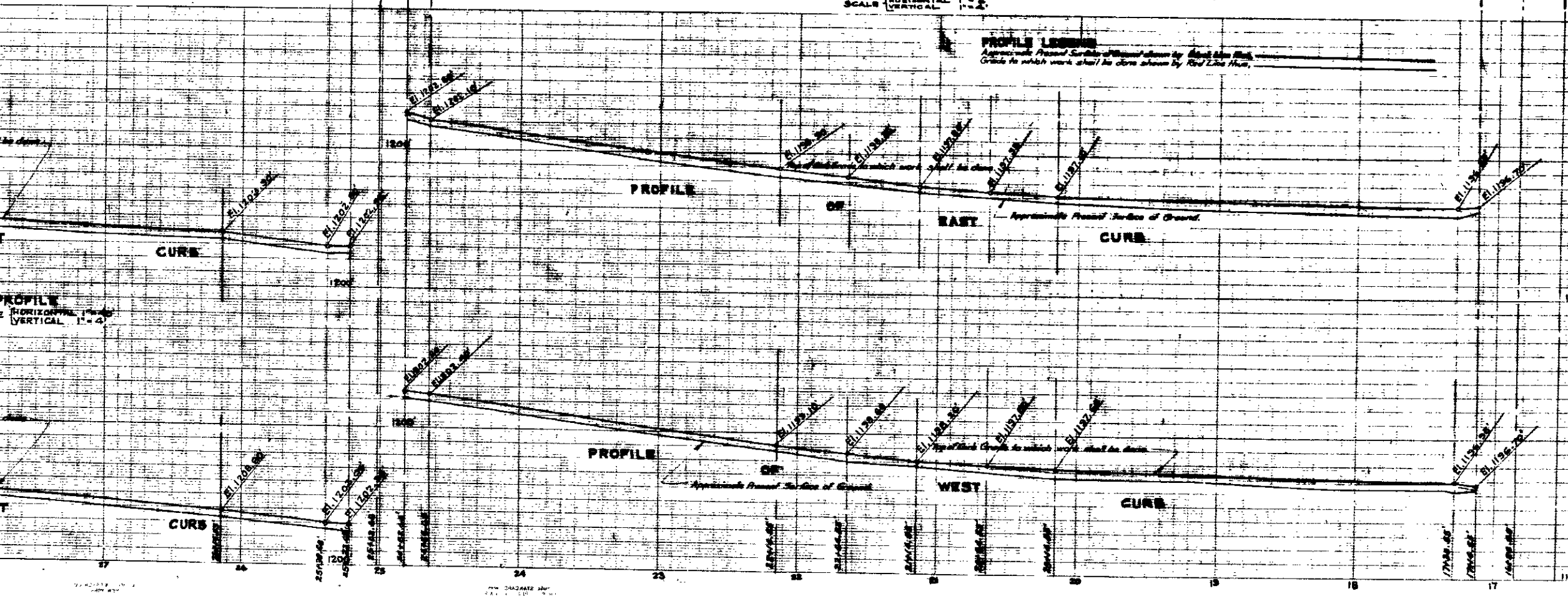
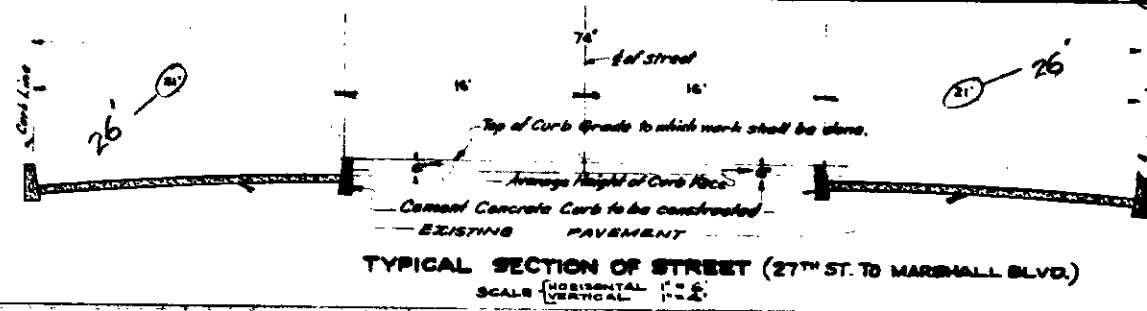
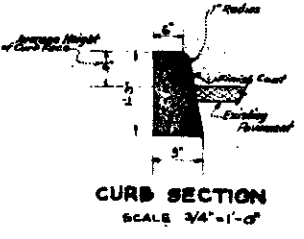
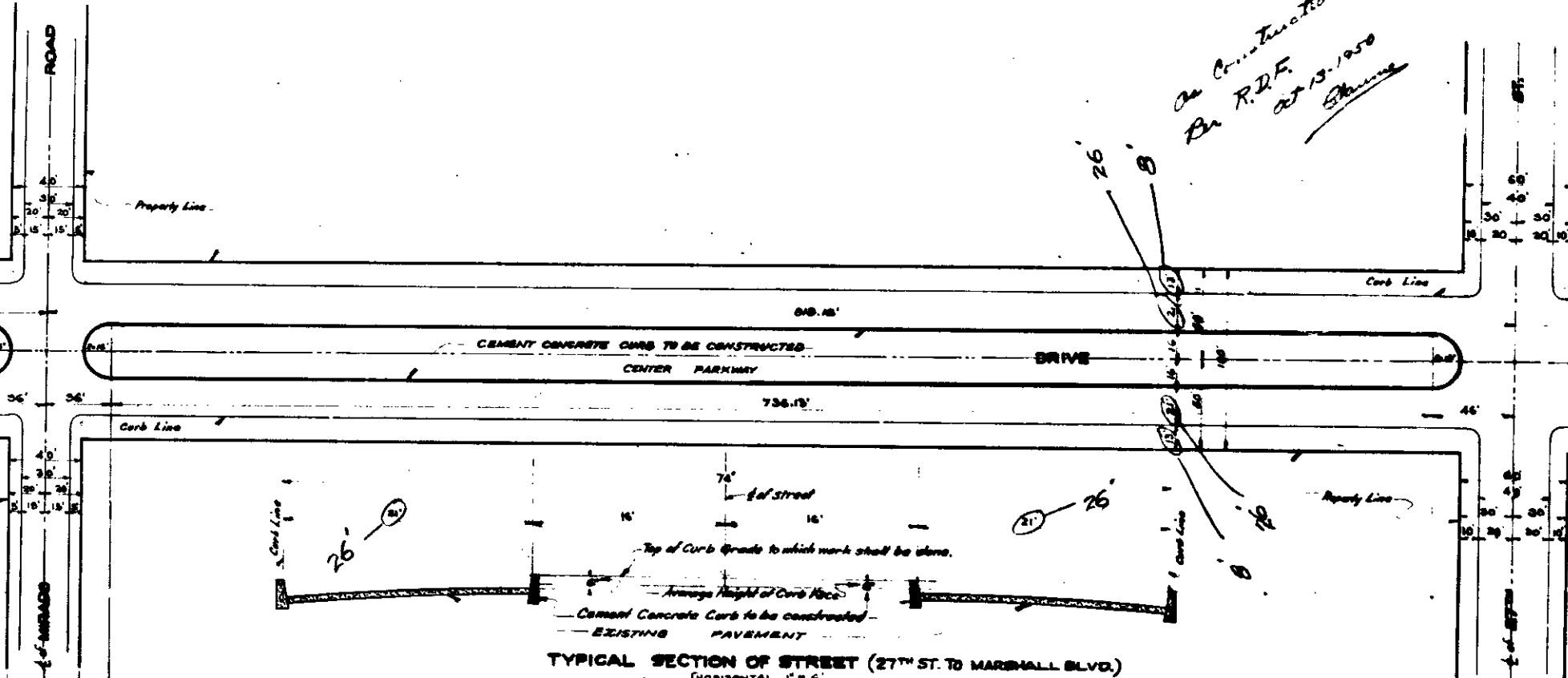

PROFILE LEGEND
Approximate Present Surface of Ground shown by Dotted Line
Grade to which work shall be done shown by Red Line

LEGEND
Curb to be constructed shown by Red Line
Cement Concrete Curb to be constructed shown by Red Line

TITLE TO STREET
MUSCUIPABE DRIVE was platted in the City of San Bernardino by Ordinance No. 1807, adopted January 30, 1928, and recorded in Book 688 of Records, of page 228, records of San Bernardino County, California, and by map of Shandin Hills, recorded in book 21 of maps at page 46, records of San Bernardino County, California.

GRADE ORDINANCE
Grade of MUSCUIPABE DRIVE was established by Resolution No. 1608 of the City of San Bernardino, California, adopted November 23, 1948. Width of Sidewalk and Curb of MUSCUIPABE DRIVE was established by Resolution No. 1833 of the City of San Bernardino, California, adopted December 6, 1948.

DATUM
All elevations shown in this plan are in feet and are above a plane which is 1043.28 feet below the City Bench Mark as established by Ordinance No. 883 of the City of San Bernardino, California.

13-1050